

EXP: Inserts for Thermo Setting Plastics

FSUK-EXPH

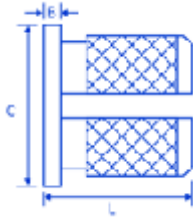

FSUK-EXP

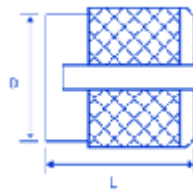

FSUK-EXPR

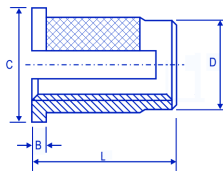

Dimensions

thread	B	C	D	L	holesize	wallthickness
M2	0,43	4,8	3,2	3.9	3,2	2,4
M2.5	0,51	5,5	4,0	4.7	4,0	3,2
M3	0,51	5,5	4,0	4.7	4,0	3,2
M3.5	0,66	6,4	4,7	6.3	4,8	3,6
M4	0,82	7,1	5,5	7.9	5,6	4,0
M5	0,99	7,9	6,3	9.4	6,4	4,8
M6	1,25	9,5	7,9	12.6	8,0	6,0
M8	1,25	11,1	9,5	12.6	9,6	7,0

Advantages

FAST AND EASY TO INSTALL

SCREW IS SECURED AUTOMATICALLY AGAINST LOOSENING

HEADED AND REVERSE HEAD AVAILABLE TO ENABLE THE INSERT TO GO ON THE BACK OF THE MOULDING

Comments

EXAMPLE DESIGNATION FSUK EXP B M4= M4 BRASS FLUSH EXPANSION INSERT

FSUK EXPH-B-M4 M4 BRASS HEADED VERSION

FSUK EXPR B M4 M4 REVERSE TYPE EXPANSION INSERT

ONLY AVAILABLE IN BRASS

MOST SIZES AVAILABLE FROM STOCK

Description

The FSUK EXP range is designed around a diamond knurl configuration with a slot which enables the insert to expand when the mating screw is assembled. This insert is designed more for Thermosetting Plastics although can be used in some Thermoplastics.

Available in a headed and reverse head; it is designed with an anti vibration feature to stop the screw working loose after assembly.

Its designed to be pressed in cold into drilled or moulded holes.