

## FSUK-MINI-ANCHOR: 4

### FSUK-MINIANCHOR

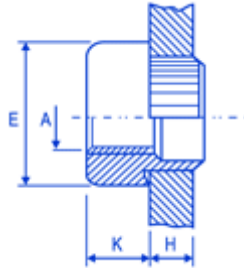

### Description

The FSUK Mini-Anchor range has all the features of the standard Anchor but with a smaller body and panel range. The spigot is designed to go through the sheet and be riveted over on the back allowing it to go into all types of material. They are generally available in Steel Self colour or Zinc and Clear Pass and Stainless Steel. The Mini bushes are designed to be almost flush on the back of the sheet and can be installed into material between 0.5mm-3mm. It is designed to be installed into drilled or punched holes.

### Dimensions

thread	E	K	holesize
M2	5.0	2.3	3.5
M2.5	5.5	2.8	4,3
M3	5.5	2.8	4,3
M3.5	7.0	3.2	5.5
M4	7.0	3.2	5.5
M5	8.5	3.8	6.5
M6	10	5.1	7.7
M8	12	6.5	9.7

### Advantages

CAN BE INSTALLED MANUALLY OR WITH AN AUTO FEED PRESS SUITABLE FOR USE IN DRILLED OR PUNCHED HOLES  
CAN BE INSTALLED CLOSE TO THE PANEL EDGE  
SMALLER BODY GIVES MORE DESIGN SPACE

### Comments

HOW TO SPECIFY: FSUK MINI-ANCHOR M4-1.6mm-S-Z  
SPECIFY MATERIAL THICKNESS (H) AND ANCHOR MATERIAL THEN FINISH AVAILABLE IN SELF COLOUR, STEEL ZINC & TRIVALENT AND STAINLESS M3&M4 AVAILABLE IN MOST GUAGE SIZES FROM STOCK