

HPS: 5

FSUK-SCHPS

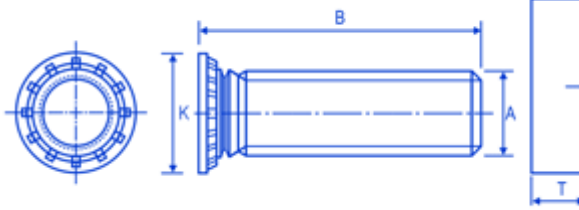

Dimensions

thread	K	L	T	holesize
M5	7.8	5.0	10.5	5.0
M6	9.4	6.0	11.5	6.0
M8	12.5	8.0	12.5	8.0
M10	15.7	10.0	13.5	10.0

Advantages

SUITABLE FOR USE IN DRILLED OR PUNCHED HOLES STUD WILL ALWAYS BE INSTALLED PERPENDICULAR TO PANEL NO WELDING REQUIRED HIGH TORQUE RESISTANCE

Comments

HOW TO SPECIFY: FSUK SCHPS M8-20 (B) STEEL TRIVALENT SOME SIZES AVAILABLE IN STAINLESS- PLEASE CLICK ON THE CONTACT US @ FSUK AND PLACE ENQUIRY TO CHECK AVAILABILITY

Description

The FSUK high-performance studs are available for applications where a flush head is not required and a very high performance is. The FSUK Self-Clinch studs persuades material from the mating sheet to flow around the self clinch groove and notches. The steel studs are hardened and designed to go into sheet less than 80 Rockwell B. It is designed to be installed into drilled or punched holes and must always be installed using a squeeze action. The tolerance on the hole must be -0.00 + 0.13mm.