

SCS: 5

FSUK-SCS

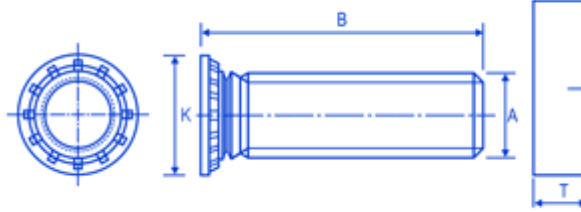

Dimensions

thread	K	L	T	sheet thickness
M2.5	4.0	2.5	0.4	1.0
M3	4.6	3.0	0.8	1.0
M4	5.9	4.0	1.9	1.0
M5	6.5	5.0	3.8	1.0
M6	8.2	6.0	8.0	1.5
M8	9.6	8.0	12.0	1.5

Description

The FSUK Self-Clinch studs is designed to be flush into a range of sheet metal without any need for welding. The studs are available in a variety of thread sizes and lengths. The FSUK Self-Clinch studs persuades material from the mating sheet to flow around the self clinch groove and notches. The steel studs are hardened and designed to go into sheet less than 80 Rockwell B, the stainless version is designed to go into less than 70 Rockwell B. It is designed to be installed into drilled or punched holes and must always be installed using a squeeze action. The tolerance on the hole must be $-0.00 + 0.08\text{mm}$

Advantages

SUITABLE FOR USE IN DRILLED OR PUNCHED HOLES HEAD IS DESIGNED TO BE INSTALLED FLUSH WITH THE SHEET AVAILABLE IN STEEL AND STAINLESS STUD WILL ALWAYS BE INSTALLED PERPENDICULAR TO PANEL NO WELDING REQUIRED

Comments

HEAD TOLERANCE $\pm 0.4\text{mm}$ HOW TO SPECIFY: THREAD SIZE X LENGTH STEEL TRIVALENT FINISH OR STAINLESS. IE FSUK M4-10 STEEL TRIVALENT PLEASE NOTE LENGTHS(B) AVAILABLE AS FOLLOWS: M3- 6/8/10/12/14/15/16/18/20/25/30/35 M4- 6/8/10/12/14/15/16/18/20/25/30/35/38 M5- 8/10/12/14/15/16/18/20/25/30/35/38 M6- 10/12/14/15/16/18/20/25/30/35/38 M8- 10/12/15/16/18/20/25/30/35/38/50 PLEASE CHECK WITH FSUK FOR AVAILABILITY OVER 30 LONG PRODUCT IS AVAILABLE IN STEEL TRIVALENT FINISH, GEOMET 500 (ONLY SOME SIZES) AND STAINLESS MOST SIZES EX STOCK